

# Assembly instructions

## RO015 RO102 RO111 RollUp Banner



### The contents of the package:

- 1 Textile carry bag: 1 piece
- 2 RollUp Banner system/box: 1 piece
- 3 Three-section pole: 3 pieces.

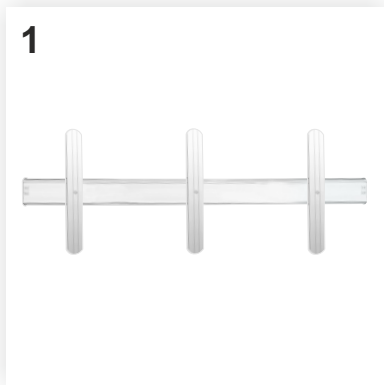

1. Place the RollUp on the floor and rotate the feet 90 degrees to the base/box.

2. Take out the three-section poles from the box, unfold the three poles and connect them together to form three long poles, as shown in the picture.



3. Insert the poles vertically into the slots located on the back side of the box, as shown in the picture. The poles must go through the box slots all the way to the base. Inserted correctly, the pole will sustain itself in two points and thus the Rollup will not swing. Please make sure that the poles are inserted to the end.

4. Gently pull out the graphic from the box with your feet stepped on the Rollup feet.

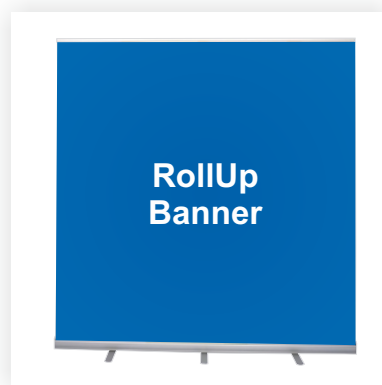
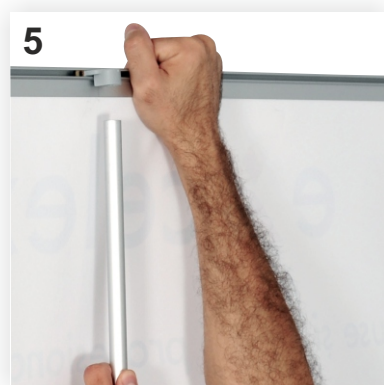

5. Pulling the graphic straight, place the end of the three-section poles into the plastic covers on the backside of the Rollup, as shown in the picture. To move the RollUp Banner is recommended to hold it from the three-section poles from the back.

The pictures are for presentation only; your product can be slightly different!